

NOTES :-



FOR FIXING INTO SFS FRAMING
4.8mm x 38mm WINGTIP FIXING



FOR FIXING INTO TIMBER FRAMING
4.2mm x 42mm FIXING

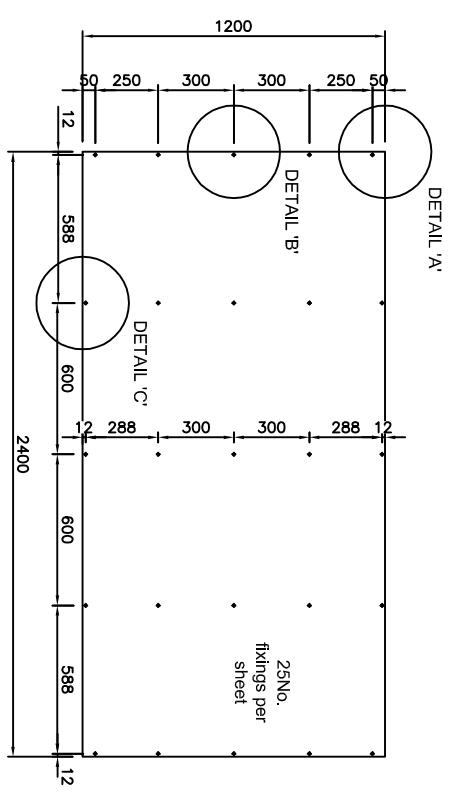
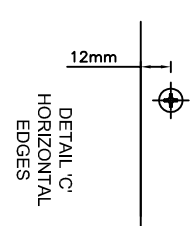
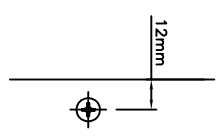
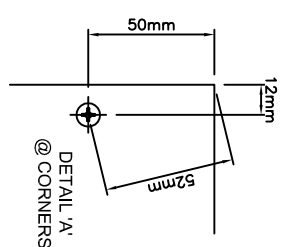
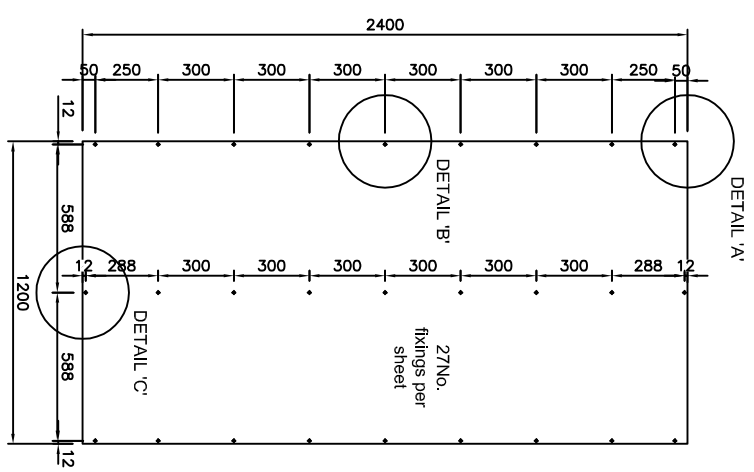

RCM - MULTIPURPOSE TYPICAL FIXING DETAILS

(NOMINAL 2mm TO 5mm JOINT GAP BETWEEN BOARDS)
MINIMUM EDGE DISTANCE 12mm

| No | DESCRIPTION | DATE |
|----|-------------|------|
| | REVISION | |

ROOFING AND CLADDING MATERIALS
MULTIPURPOSE
TYPICAL BOARD FIXING GUIDE

| | | | |
|---------|-----------|----------|----|
| SCALE | NTS | DRAWN | PM |
| DATE | 16/07/18 | CHECKED | |
| DWG. No | RCM ST103 | REVISION | - |



RCM, 27 Rosevale Road, Parkhouse Ind Estate West,
Newcastle Under Lyme, Staffordshire, ST5 7EF
Tel: 0800 6124662